



**Make: Belle**  
**Model: PCLX12/40**  
**Description: Lightweight Electric Vibrating Compactor Plate**



This lightweight plate compactor is a professional-grade machine designed for efficient compaction tasks, especially in indoor or poorly ventilated areas. Equipped with a high-performance 12kN vibration unit, it ensures excellent travel speed and compaction force, reducing operating times. The environmentally friendly 1.5kW electric motor operates with zero emissions, making it ideal for night-time and urban projects. Additional features include a low HAV design for extended safe usage, a centrifugal clutch for a soft start and robust construction suitable for heavy contractor use.

**Specification:**  
**Class 1 earthed appliance.**  
**Integrated motor protection guard.**  
**Block paving pad option available.**  
**Available in 110v or 240v.**

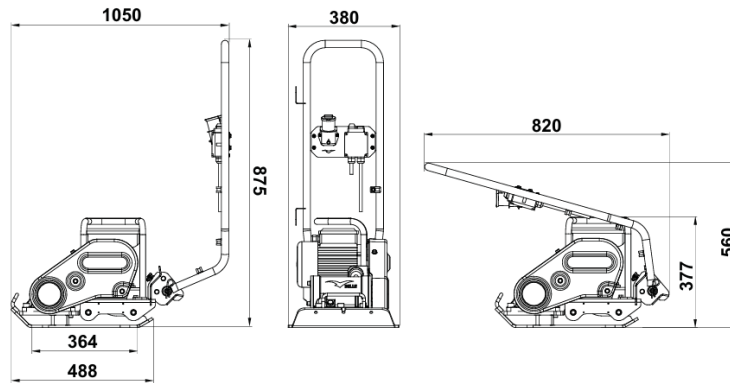

Model	110v 50Hz	230v 50Hz
Weight (kg)	50	50
Motor Power (Hp / kW)	2.0 / 1.5	2.0 / 1.5
Motor RPM	2800	2800
Nominal Voltage (v)	110	230
Full Load Current (A)	14.2	6.66
Motor Protection Rating	IP44	IP44
Power Consumption (kW)	0.94	0.94
Vibrator Force (kN)	12	12
Frequency (Hz)	50	50
Minimum Transformer Size (kVA)	3.3	N/A
Maximum Travel Speed (m/min)	24	24
Max. Gradient (°)	20	20
Compaction Force (kg/m <sup>2</sup> )	388	388
3 Axis Vibration* (m/sec <sup>2</sup> )	3.97	3.97
Usage Time (Mins)	190	190
Sound Power Level (dB(A))	104	104

\* Minimum level to EN500 Part 4