

# GASS COMPONENT CHART

# SGB

## formwork

### Outer Leg

Code No.	Length L (mm)	Height range (m)	Weight (kg)
718001	1400	1.49 – 2.73	8.04
718002	2490	2.58 – 3.82	12.73
718003	3580	3.67 – 4.91	17.41
718004	4670	4.76 – 6.00	22.10

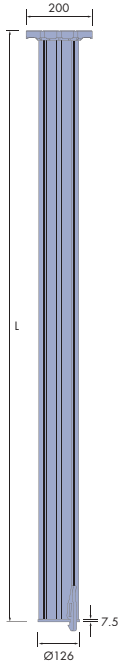

### Inner Leg

Code No.	Length L (mm)	Weight (kg)
718015	780	5.5
718014	1400	8.7
718016	1680	10.2
718017	2800	13.7

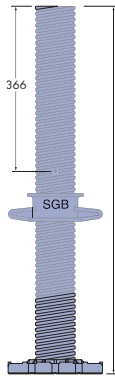

### Ledger Frames

Frame length (m)	Code No.	Weight (kg)
1.2	718020	9.4
1.8	718021	10.3
2.4	718022	13.4
3.0	718023	15.8

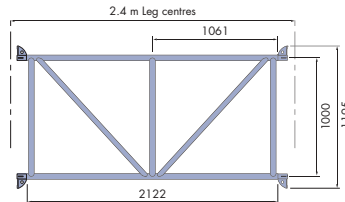

### Ring Nut & Bolt (head to head plate)

Description	Code No.	Weight (kg)
Hex bolt and ring nut c/w washers	718901	0.35
Hex bolt and hex nut c/w washers	718902	0.35

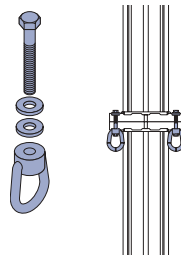

### GASS T Bolt (head to beam)

Description	Code No.	Weight (kg)
T bolt and ring nut c/w washers	718904	0.60
T bolt and hex nut c/w washers	718099	0.60

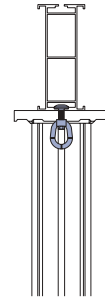

### GASS Ring Bolt Soldier Connector

Code No. 718096  
Weight: 0.35 kg

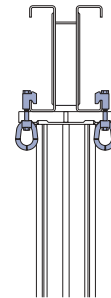

### Rocking Head Base Plate

Code No. 718091  
Weight: 8.25 kg

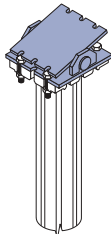

### Spanner

Code No. 718063  
Weight: 6.4 kg

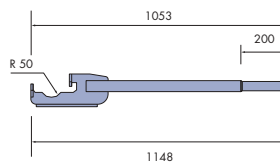

### Extension Leg

Size: 500 mm  
Code No. 718007  
Weight: 5.63 kg

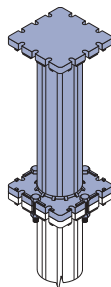

### GASS Castor and Shoe

Code No. 718079  
Weight: 9.8 kg

