



Operator's manual

Cutting machine

RCP

12, 16, 32



EN

5000191615	04	0811
------------	----	------



0215050en	004
08.2011	



Manufacturer

Wacker Neuson Produktion GmbH & Co. KG
Preußenstraße 41
80809 München
www.wackerneuson.com

Tel.: +49-(0)89-354 02-0
Fax: +49-(0)89-354 02-390

Translation of the original operator's manual in German



**WACKER
NEUSON**

1	Foreword	5
2	Introduction	6
2.1	Means of representation for this operator's manual	6
2.2	Wacker Neuson representative	7
2.3	Described machine types	7
2.4	Identification of the machine	8
3	Safety	9
3.1	Principle	9
3.2	Qualification of the operating personnel	12
3.3	Protective gear	13
3.4	Transport	14
3.5	Operating safety	14
3.6	Safety during the operation of hand machines	16
3.7	Safety during the operation of electric appliances	16
3.8	Safety during the operation of hydraulic machines	18
3.9	Maintenance	18
3.10	Safety and information labels	19
3.11	Safety devices	20
4	Scope of delivery	21
5	Description	22
5.1	Application	22
5.2	Functionality	22
5.3	Components and operator's controls	23
6	Transport	26
7	Operation	27
7.1	Prior to starting the machine	27
7.2	Adjusting the machine	28
7.3	Starting up	31
7.4	Decommissioning	35
8	Maintenance	36
8.1	Maintenance schedule	36
8.2	Maintenance work	37
8.2.1	Visual inspection for damage	37
8.2.2	Changing the knife on the RCP-12	38
8.2.3	Changing the knife on the RCP-16	41

8.2.4	Changing the knife on the RCP-32	45
8.2.5	Adjusting the stroke for RCP-12	46
8.2.6	Adjusting the stroke for RCP-16	48
8.2.7	Checking the hydraulic oil level	50
8.2.8	Changing the hydraulic oil	52
9	Troubleshooting	55
10	Disposal	56
10.1	Disposal of waste electrical and electronic equipment	56
11	Accessories	57
12	Technical data	58
12.1	RCP-12/16/32 - 230	58
12.2	RCP-12/16/32 - 115	59
12.3	RCP-12/16/32 - 120	60
12.4	Extension cable	61
13	Glossary	65
	EC Declaration of Conformity	67



1 Foreword

This operator's manual contains information and procedures for the safe operation and maintenance of your Wacker Neuson machine. In the interest of your own safety and to prevent accidents, you should carefully read through the safety information, familiarize yourself with it and observe it at all times.

This operator's manual is not a manual for extensive maintenance and repair work. Such work should be carried out by Wacker Neuson service or authorized specialists.

The safety of the operator was one of the most important aspects taken into consideration when this machine was designed. Nevertheless, improper use or incorrect maintenance can pose a risk. Please operate and maintain your Wacker Neuson machine in accordance with the instructions in this operator's manual. Your reward will be troublefree operation and a high degree of availability.

Defective machine parts must be replaced immediately!

Please contact your Wacker Neuson representative if you have any questions concerning operation or maintenance.

All rights reserved, especially reproduction and distribution rights.

Copyright 2011 Wacker Neuson Produktion GmbH & Co. KG

No part of this publication may be reproduced in any form or by any means, electronic or mechanical, including photocopying, without the expressed written permission of Wacker Neuson.

Any type of reproduction, distribution or storage on data media of any type and form not authorized by Wacker Neuson represents an infringement of copyright and will be prosecuted.

We expressly reserve the right to make technical modifications – even without special notice – which aim at further improving our machines or their safety standards.

2 Introduction

2.1 Means of representation for this operator's manual

Warning symbols

This operator's manual contains safety information of the categories: DANGER, WARNING, CAUTION, NOTICE.

They should be followed to prevent danger to life and limb of the operator or damage to equipment and exclude improper service.



DANGER

This warning notice indicates immediate hazards that result in serious injury or even death.

- Danger can be avoided by the following the actions mentioned.
-



WARNING

This warning notice indicates possible hazards that can result in serious injury or even death.

- Danger can be avoided by the following the actions mentioned.
-



CAUTION

This warning notice indicates possible hazards that can result in minor injury.

- Danger can be avoided by the following the actions mentioned.
-

NOTICE

This warning notice indicates possible hazards that can result in material damage.

- Danger can be avoided by the following the actions mentioned.
-

Notes

Note: Complementary information will be displayed here.

Instructions

- ▶ This symbol indicates there is something for you to do.
- 1. Numbered instructions indicate that you have to carry out something in a defined sequence.
- This symbol is used for lists.

2.2 Wacker Neuson representative

Depending on your country, your Wacker Neuson representative is your Wacker Neuson service, your Wacker Neuson affiliate or your Wacker Neuson dealer.

You can find the addresses in the Internet at www.wackerneuson.com.

The address of the manufacturer is located at the beginning of this operator's manual.

2.3 Described machine types

This operator's manual is valid for different machine types from a product range. Therefore some figures can differ from the actual appearance of your machine. It is also possible that the descriptions include components which are not a part of your machine.

Details for the described machine types can be found in the chapter *Technical data*.

2.4 Identification of the machine

Nameplate data

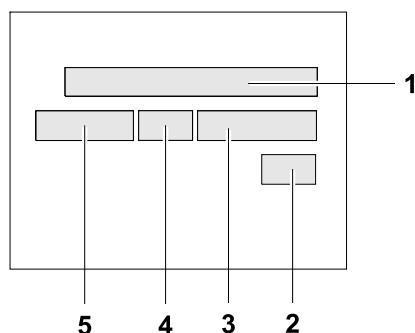

The nameplate lists information that uniquely identifies your machine. This information is needed to order spare parts and when requesting additional technical information.

► Enter the information of your machine into the following table:

Item	Designation	Your information
1	Group and type	
2	Construction year	
3	Machine no.	
4	Version no.	
5	Item no.	

3 Safety

3.1 Principle

State of the art

This machine has been constructed with state-of-the-art technology according to the recognized rules of safety. Nevertheless, when used improperly, dangers to the life and limb of the operator or to third persons or damage to the machine or other materials cannot be excluded.

Proper use

The machine may only be used for cutting reinforcing steel.

The diameter and tensile strength of the reinforcing steel that may be processed with the machine are dependent on the machine design. Please refer to the chapter *Technical Data* for information concerning your machine.

Worksites are construction sites and operations which fabricate reinforcements or process reinforcing iron. The machine may only be used for legal and permitted purposes.

The machine must not be used for processing the following materials:

- Wires
- Pipes
- Plastics
- Wood

Its proper use also includes the observance of all instructions contained in this operator's manual as well as complying with the required service and maintenance instructions.

Any other use is regarded as improper. Any damage resulting from improper use will void the warranty and the liability on behalf of the manufacturer. The operator assumes full responsibility.

Structural modifications

Never attempt to modify the machine without the written permission of the manufacturer. To do so will endanger your safety and the safety of other people! In addition, this will void the warranty and the liability on behalf of the manufacturer.

Especially the following are cases of structural modifications:

- Opening the machine and the permanent removal of components from Wacker Neuson.
- Installing new components which are not from Wacker Neuson and not equivalent to the original parts in design and quality.
- Installation of accessories which are not from Wacker Neuson.

It is no problem to install spare parts from Wacker Neuson.

It is no problem to install accessories that are available in the Wacker Neuson product range of your machine. Please refer to the installation regulations in this operator's manual.

Do not drill into the housing, e.g. to install signs. Water could penetrate the housing and damage the machine.

Requirements for operation

The ability to operate the machine safely requires:

- Proper transport, storage and setup.
- Careful operation.
- Careful service and maintenance.

Operation

Operate the machine only as intended and only when in proper working condition.

Operate the machine in a safety-conscious manner with all safety devices attached and enabled. Do not modify or disable any safety devices.

Before starting operation, check that all control and safety devices are functioning properly.

Never operate the machine in a potentially explosive environment.

Supervision

Never leave the machine running unattended!

Maintenance

Regular maintenance work is required in order for the machine to operate properly and reliably over time. Failure to perform adequate maintenance reduces the safety of the machine.

- Strictly observe the prescribed maintenance intervals.
- Do not use the machine if it requires maintenance or repairs.

Malfunctions

If you detect a malfunction, you must shut down and secure the machine immediately.

Eliminate the malfunctions that impair safety immediately!

Have damaged or defective components replaced immediately!

For further information, refer to chapter *Troubleshooting*.

Spare parts, accessories

Use only spare parts from Wacker Neuson or such that are equivalent to the original parts in design and quality.

Only use accessories from Wacker Neuson.

Non-compliance will exempt the manufacturer from all liability.

Exclusion of liability

Wacker Neuson will refuse to accept liability for injuries to persons or for damage to materials in the following cases:

- Structural modifications.
- Improper use.
- Failure to comply with this operator's manual.
- Improper handling.
- Using of spare parts which are not from Wacker Neuson and not equivalent to the original parts in design and quality.
- Using of accessories which are not from Wacker Neuson.

Operator's manual

Always keep the operator's manual near the machine or near the worksite for quick reference.

If you have misplaced the operator's manual or require an additional copy, contact your Wacker Neuson representative or download the operator's manual from the Internet (www.wackerneuson.com).

Always hand over this operator's manual to other operators or to the future owner of the machine.

Country-specific regulations

Observe the country-specific regulations, standards and guidelines in reference to accident prevention and environmental safety, for example those pertaining to hazardous materials and wearing protective gear.

Complement the operator's manual with additional instructions taking into account the operational, regulatory, national or generally applicable safety guidelines.

Operator's controls

Always keep the operator's controls of the machine dry, clean and free of oil or grease.

Operating elements such as ON/OFF switch, gas handles etc. may not be locked, manipulated or changed without authorization.

Checking for signs of damage

Inspect the machine when it is switched off for any signs of damage at least once per work shift.

Do not operate the machine if there is visible damage or defects.

Have any damage or defects eliminated immediately.

3.2 Qualification of the operating personnel

Operator qualifications

Only trained personnel are permitted to start and operate the machine. The following rules also apply:

- You are physically and mentally fit.
- You have received instruction on how to independently operate the machine.
- You have received instruction in the proper use of the machine.
- You are familiar with required safety devices.
- You are authorized to start machines and systems in accordance with the standards governing safety.
- Your company or the operator has assigned you to work independently with this machine.

Incorrect operation

Incorrect operation or misuse by untrained personnel can endanger the health and safety of the operator or third persons and also cause machine and material damage.

Operating company responsibilities

The operating company must make the operator's manual available to the operator and ensure that the operator has read and understood it.

Work recommendations

Please observe the recommendations below:

- Work only if you are in a good physical condition.
- Work attentively, particularly as you finish.
- Do not operate the machine when you are tired.
- Carry out all work calmly, circumspectly and carefully.
- Never operate the machine under the influence of alcohol, drugs or medication. This can impair your vision, reactions and your judgment.
- Work in a manner that does not endanger others.
- Ensure that no persons or animals are within the danger zone.

3.3 Protective gear**Work clothing**

Clothing should be appropriate, i.e. should be close-fitting but not restrict your movement.

When on construction sites, do not wear long hair loosely, loose clothing or jewelry including rings. These objects can easily get caught or be drawn in by moving machine parts.

Only wear clothing made of material that is not easily flammable.

Personal protective gear

Wear personal protective gear to avoid injuries or health hazards:

- Non-skid, hard-toed shoes.
- Work gloves made of durable material.
- Overalls made of durable material.
- Hard hat.
- Ear protection.
- Face protection.
- Eye protection.
- Breathing protection in the case of dusty ambient air.

3.4 Transport

Switching off the machine

Before you transport the machine, switch it off and pull the plug out of the plug receptacle. Allow the motor to cool down.

Transporting the machine

Transport the machine in the carrying case supplied.

Secure the carrying case on the transport device against tilting, falling or slipping.

Lifting the machine

A falling machine can cause serious injuries.

The machine has no lifting or lashing points.

When lifting the machine, secure it in a closed transport container or similar in order to prevent it from toppling, falling or slipping away.

Restarting

Machines, machine parts, accessories or tools that were detached for transport purposes must be re-mounted and fastened before restarting.

Only operate in accordance with the operating instructions.

3.5 Operating safety

Explosible environment

Never operate the machine in a potentially explosive environment.

Work environment

Familiarize yourself with your work environment before you start work. This includes e.g. the following items:

- Obstacles in the work and traffic area.
- Load-bearing capacity of the ground.
- The measures needed to cordon off the construction site from public traffic in particular.
- The measures needed to secure walls and ceilings.
- Options available in the event of an accident.

Safety in the work area

When working with the machine especially pay attention to the following points:

- Electric lines or pipes in work area.
- Gas lines or water lines in the work area.

Checks before starting work

Check the following points before beginning work:

- Condition of tools.
- Machine settings.
- Connection value of the machine.

Starting the machine

Observe the safety information and warning notices located on the machine and in the operator's manual.

Never attempt to start a machine that requires maintenance or repairs.

Start the machine as described in the operator's manual.

Vertical stability

Always make sure that you stand firmly when working with the machine. This applies particularly when working on scaffoldings, ladders, uneven or slippery floors etc.

Caution with movable parts

Keep your hands, feet and loose clothing away from moving machine parts.

No persons endangered

Be sure that no persons are endangered by flying or falling materials. Always work very attentively, and anticipate potential hazards.

Switching off the machine

Switch off the machine and pull the plug out of the plug receptacle in the following situations:

- Before breaks.
- If you are not using the machine.
- If you are changing the tool.

Before storing the machine, wait until it has completely stopped running.

Store the machine or put it down in such a way that it cannot tilt, fall down or slip.

Storage

Set the machine down or store it securely so that it cannot tilt, fall down or slip.

Storage location

After operation, allow the machine to cool and then store it in a sealed-off, clean and dry location protected against frost and inaccessible to children.

3.6 Safety during the operation of hand machines

Safe working with hand machines

Secure loose workpieces with suitable methods.

While working, as a rule hold the machine on the provided handles with both hands.

3.7 Safety during the operation of electric appliances

Specific regulations for electrical appliances

Observe the safety information provided in the brochure *General Safety Rules* which is included in the scope of delivery of your machine.

Also observe the country-specific regulations, standards and guidelines in reference to accident prevention in connection with electrical equipment and machines.

 **WARNING Read all safety information and instructions.** Failure to follow the safety information and instructions may result in electric shock, fire and/or serious injury.

Save all safety information and instructions for future reference.

Electric power supply for electrical appliances of class rating II

Note: The rated voltage is indicated on the nameplate of your machine.

The machine may only be connected to an electric power supply with all machine parts in proper working condition. Take special notice of the following components:

- Plug.
- Power cable over the entire length.
- Switch diaphragm of the ON/OFF switch, if there is one.
- Plug receptacles.

Electrical appliances of class rating II have a strengthened or double insulation (protective insulation). They have no connection to the grounded conductor.

There must be at least one of the following safety devices if connected to a stationary or mobile generator:

- Fault current protective switch.
- Isolation (earth leakage) monitor.
- IT-net.

Note: Observe the respective national safety regulations!

Extension cable

The machine may only be operated with undamaged and tested extension cables!

Only use extension cables with grounded conductor and correct connection of the grounded conductor to the plug and coupling (only for machines of class rating I, see chapter *Technical data*).

Only use tested extension cables which are suitable for use at construction sites: Average rubber hose H05RN-F or better – Wacker Neuson recommends H07RN-F, an SOOW cable, or a country-specific equivalent design.

Immediately replace damaged extension cables (e.g. tears in the sheathing) or loose plugs and couplings.

Cable drums and multiple plug receptacles must fulfill the same requirements as the extension cable.

Protect extension cables, multiple plug receptacles, cable drums and connection couplings against rain, snow or any other forms of moisture.

Uncoil the cable drum completely

Danger of fire due to wound cable drum.

Uncoil the cable drum completely before operation.

Protecting the power cable

Do not use the power cable to pull or lift the machine.

Do not unplug the power cable by pulling on the cable.

Protect the power cable from heat, oil and sharp edges.

If the power cable is damaged or the plug is loose, have it replaced immediately by your Wacker Neuson representative.

Protecting from moisture

Protect the machine against rain, snow or any other forms of moisture. This could cause damage or other malfunctions.

Protecting against extreme high or low temperatures

Do not expose the machine to extreme high or low temperatures. Otherwise the insulation current conducting parts can be damaged.

Information on the permissible temperature range can be found in the chapter *Technical Data*.

3.8 Safety during the operation of hydraulic machines

Hydraulic oil

Hydraulic oil is harmful to health.

Wear safety glasses and safety gloves when handling hydraulic oil.

Avoid direct skin contact with hydraulic oil. Remove hydraulic oil from the skin immediately with soap and water.

Make sure that no hydraulic oil comes gets in the eyes or on the body. See a physician immediately if hydraulic oil gets into the eyes or is swallowed.

Do not eat and drink while handling hydraulic oil.

Make sure to have extreme cleanliness. Contamination of the hydraulic oil with dirt or water can cause premature wear or failure of the machine.

Dispose of left over and spilled hydraulic oil according to the applicable regulations for environmental protection.

3.9 Maintenance

Maintenance work

Service and maintenance work must only be carried out to the extent described in these operating instructions. All other procedures must be performed by your Wacker Neuson representative.

For further information, refer to chapter *Maintenance*.

Disconnecting the machine from the electric power supply

Before carrying out service or maintenance work, pull the plug out of the plug receptacle in order to disconnect the machine from the electric power supply.

Cleaning

Always keep the machine clean and be sure to clean it each time you have finished using it.

Do not use gasoline or solvents. Danger of explosion!





Do not use high pressure washers. Permeating water can damage the machine. When electrical equipment is present, this can pose a serious injury risk from electric shocks.

3.10 Safety and information labels

Your machine has adhesive labels containing the most important instructions and safety information.

- Make sure that all the labels are kept legible.
- Replace any missing or illegible labels.

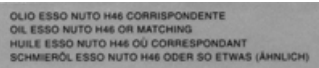
The item numbers for the labels are in the parts book.

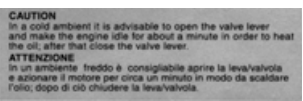
Label	Description
	Wear safety glasses. Wear hard hat. Follow operator's manual. Wear ear protection. Wear protective gloves. Wear non-skid, hard-toed shoes.
	Max. workpiece diameter.
	Only use hydraulic oil of type HLP-ISO-46 (e.g. ESSO NUTO H46), refer to chapter <i>Technical data</i> .
	WARNING Danger due to cutting. WARNING Flying chips.
	Warm up machine at temperatures under 5 °C.

3.11 Safety devices



WARNING

Danger of injury due to open moving parts.

- ▶ Only operate the machine with properly installed and functioning safety devices.
 - ▶ Do not modify or remove safety devices.
-

Protective hood

A protective hood is installed for some machine designs.

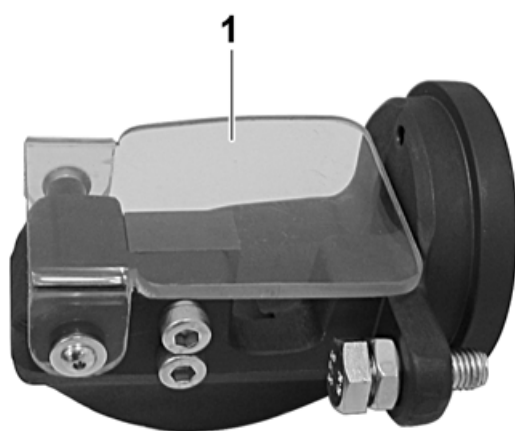

Item	Designation
1	Protective hood

4 Scope of delivery

The machine is delivered fully assembled.

The scope of delivery includes:

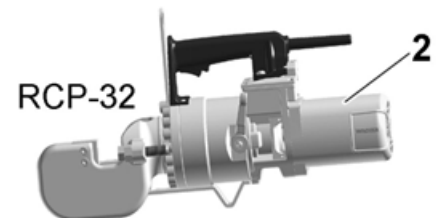
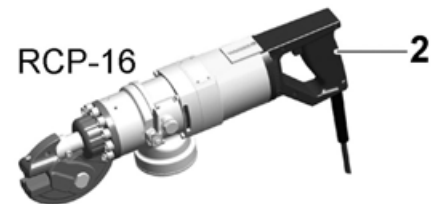
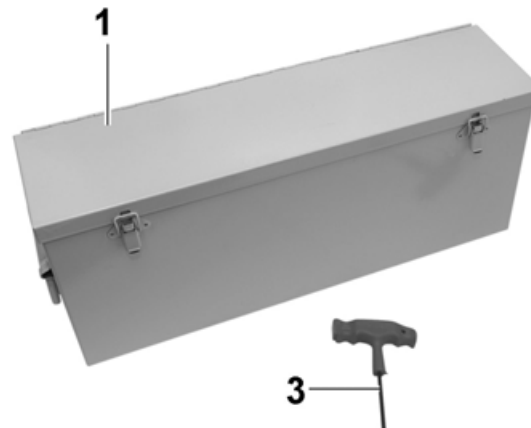

Item	Designation
1	Carrying case
2	Cutting machine
3	4 mm Allen wrench
	Operator's Manual (without illustration)
	Spare parts catalog (without illustration)
	General safety information (without illustration)

Only one cutting machine is included in the scope of deliver.

5 Description

5.1 Application

Use the machine only as intended, see chapter Safety, Proper use.

5.2 Functionality

Principle

An electric motor drives a piston with thrust bolt forwards via a gear pump.

A valve opens at the end of the forward movement and releases the pressure. A spring presses the piston back in the original position.

In cutting operating the thrust bolt moves a moveable knife against a fixed knife in the cutting head.

In idle a valve is opened via the pressure release lever. The thrust bolt does not make a movement.

5.3 Components and operator's controls

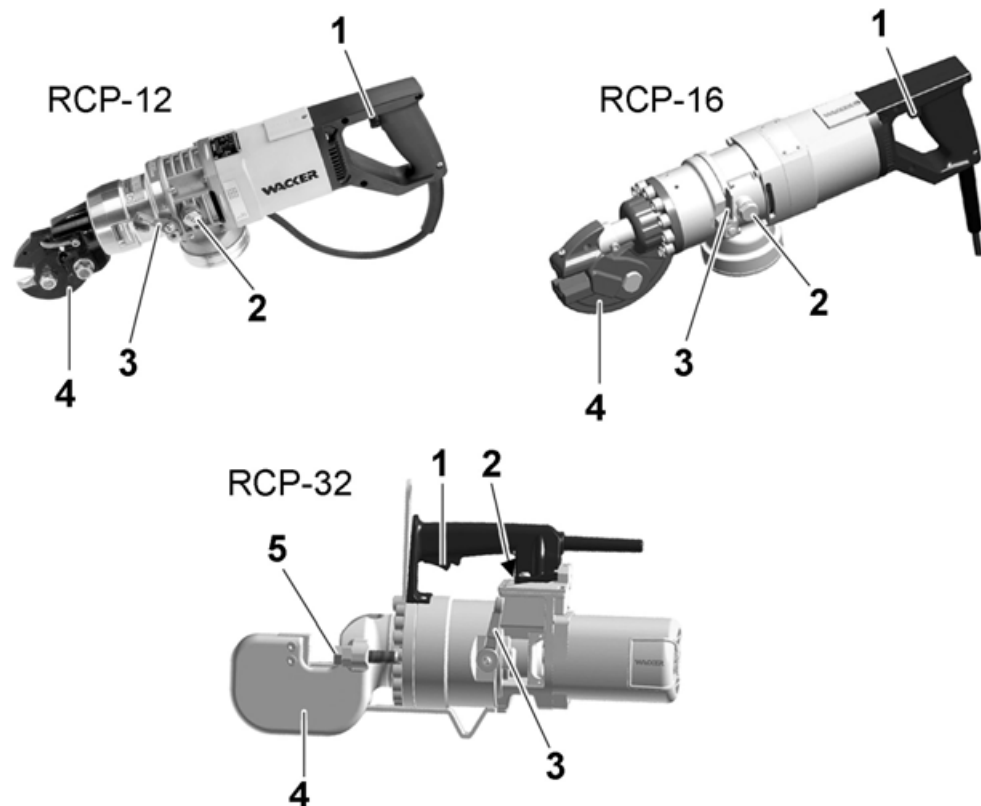

Item	Designation
1	ON/OFF switch
2	Oil filler neck
3	Pressure release lever
4	Cutting head
5	Stop screw
	Protective hood on RCP-32 (without illustration)

ON/OFF switch

Switching on the machine

Turn on the machine with the ON/OFF switch. As long as the ON/OFF switch is pressed, the machine runs in cutting operation or idle, depending on the setting of the pressure release lever.

Switching off the machine

If the ON/OFF switch is released, the motor stops. In cutting operation the movable knife stops in the current position.

Continuing the cutting movement after stop

If the ON/OFF switch is pressed again after a stop in the cutting operation, the knife continues its movement.

Oil filler neck

The oil filler neck is used for filling and emptying the hydraulic oil tank.

A screw plug with sealing ring seals the opening in the oil filler neck.

Pressure release lever

Select operating mode cutting operation or release/idle with the pressure release lever.

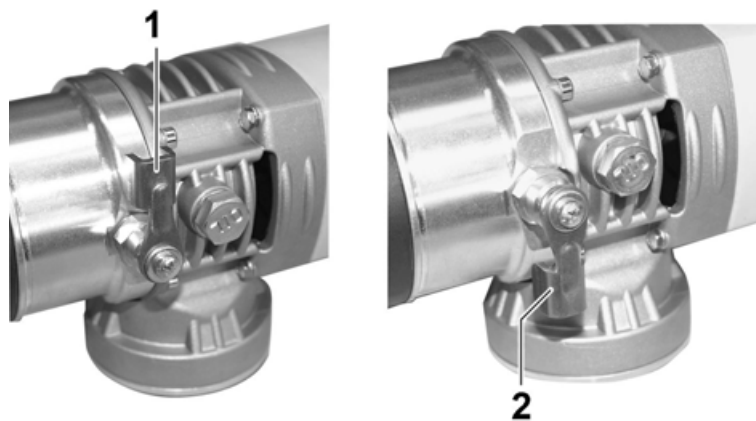

Item	Designation
1	Cutting operation ("I")
2	Release/Idle ("0")

Operating mode cutting operation

When the ON/OFF switch is pressed the machine completes a complete cutting movement and returns to the original position.

Release/Idle operating mode

When the ON/OFF switch is pressed, the machine runs without performing a cutting movement.

If the knife jams during cutting movement, the cutting movement can be interrupted. For this the machine has to be switched off and the pressure release lever has to be switched to the position Release/Idle. The knife moves into the original position.

Cutting head

One fixed knife and one movable knife are installed in the cutting head. Depending on the design of the cutting head, the knives in the cutting head are arranged differently to each other.

Cutting of the workpiece is done by shearing off or squeezing off.

Stop screw

Cutting heads in which the workpiece is cut by shearing off have a stop screw.

The stop screw must be set to the diameter of the workpiece before cutting.

If the stop screw is properly adjusted, the machine cuts the workpiece in a right angle without canting.

Protective hood

Machine designs, which cut the workpiece by shearing off, have a protective hood at the cutting head.

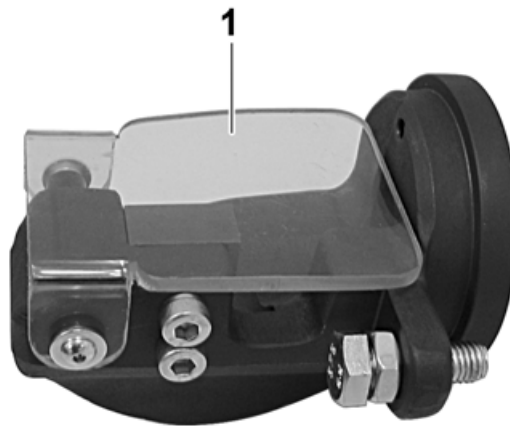

Item	Designation
1	Protective hood

Close the protective hood before cutting to avoid injuries.

6 Transport



WARNING

Improper handling can result in injury or serious material damage.

- Read and follow all safety instructions of this operator's manual, see chapter *Safety information*.
-

Transporting the machine

The machine must be transported in the carrying case supplied.

1. Pull the plug from the plug receptacle.
2. Close the protective hood (only installed on some machine designs).
3. Place the machine in the carrying case.
4. Wind up the power cable and place in the carrying case.
5. Store the Allen wrench in the carrying case.
6. Close carrying case.
7. Place the carrying case on or into a suitable means of transport.
8. Secure the carrying case against falling over and down or sliding.



7 Operation



WARNING

Improper handling can result in injury or serious material damage.

- ▶ Read and follow all safety instructions of this operator's manual, see chapter *Safety information*.
-



WARNING

Movable knives.

Body parts could be cut off.

- ▶ Do not touch the cutting head when the motor is running.
 - ▶ Close protective hood (if there is one).
-

7.1 Prior to starting the machine

After unpacking, the machine is ready for operation.

Plug

The machine comes with a country-specific plug as a standard equipment.

Carrying out checks

- ▶ Check if mains or power distribution on the construction site have the correct operating voltage (see nameplate of the machine or chapter *Technical Data*).
- ▶ Check if mains or power distribution on the constructions site are protected in accordance with current standards and regulations.

7.2 Adjusting the machine



WARNING

Starting the machine!

Danger of injuries from uncontrolled starting of the machine.

- Remove the plug from the plug receptacle before all work on the machine.
-

Adjusting the stop screw for RCP-32

The machine has a cutting head by which the knife cuts the workpiece by shearing off. The stop screw must be set to the diameter of the workpiece for this cutting head.

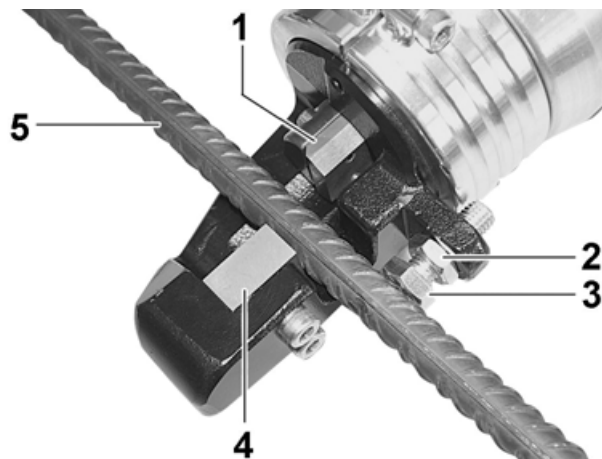

Item	Designation
1	Movable knife
2	Jam nut
3	Stop screw
4	Fixed knife
5	Workpiece
	Protective hood (without illustration)

1. Set the pressure release lever in the Release/Idle position.
2. Loosen jam nut.
3. Open the protective hood (only installed on some machine designs).
4. Place the workpiece on the fixed knife.
5. Set the stop screw so that the workpiece is perpendicular to the axis of the machine.
6. Tighten the jam nut.

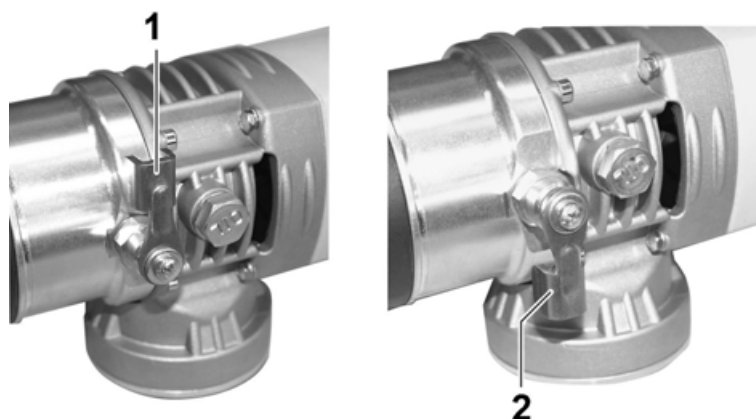
Selecting the operating mode

Item	Designation
1	Cutting operation ("I")
2	Release/Idle ("0")

- ▶ Position the pressure release lever upwards, to start the cutting operation.
- ▶ Position the pressure release lever downwards, to start idle.

7.3 Starting up

NOTICE

Worn out knives.

Premature wear of the machine.

- ▶ Before beginning work check the sharpness of the knife visually.
 - ▶ Change worn out knives.
-

Connecting the machine to the power supply

NOTICE

Electrical voltage.

Incorrect voltage can cause damage on the machine.

- ▶ Check if the voltage of the current source corresponds with the information of the machine, see chapter *Technical Data*.
-



CAUTION

Electrical voltage.

Danger due to short circuit.

- ▶ Check power cable for signs of damage.
-

1. If required, connect the machine to a permitted extension cable.

Note: See chapter *Technical data* for the permitted lengths and cross-section areas of extension cables.

2. Insert the plug into the plug receptacle.

Running the machine in idle

Note: If the machine is exposed to an ambient temperature under 5 °C, warm up in idle approx. 1 minute before beginning work on the machine.

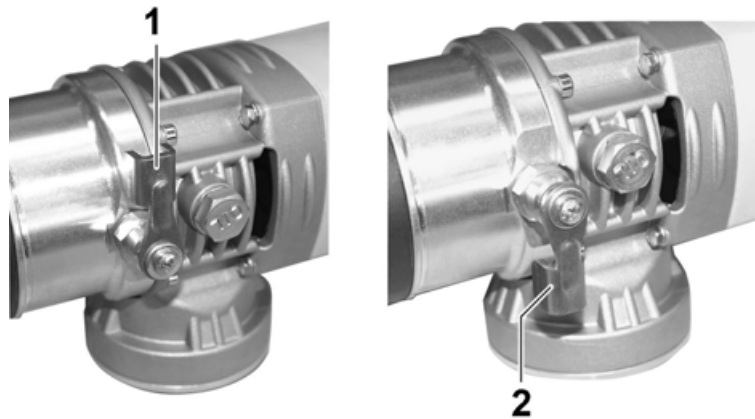

Item	Designation
1	Cutting operation ("I")
2	Release/Idle ("0")

1. Set the pressure release lever in the Release/Idle position.
2. Press and hold ON/OFF switch.
The machine runs in idle.
3. Release the ON/OFF switch to turn off.

Cutting with RCP-12 and RCP-16

**WARNING**

Injuries from insufficiently guided or uncontrolled machine.

Body parts could be cut off.

- ▶ If the machine is guided to the workpiece, the machine must always be held tight with both hands and stand securely.
- ▶ If the machine is on a stable foundation, hold the machine with one hand on the handle and hold the workpiece with the other hand.

NOTICE

Incorrect placement.

Premature wear of the knife.

- ▶ Make sure that the cutting head and workpiece are perpendicular to each other.

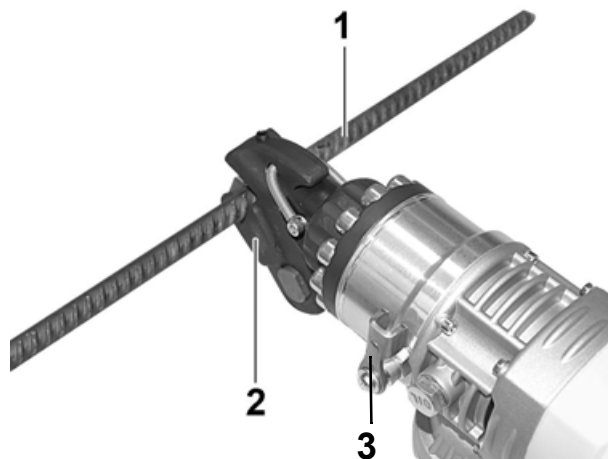

Item	Designation
1	Workpiece
2	Cutting head
3	Pressure release lever

1. Set pressure release lever in cutting operation position.
2. Set cutting head on workpiece.
3. Press and hold ON/OFF switch.
4. If the knife again is in the original position, release the ON/OFF switch.

Cutting with RCP-32



WARNING

Injuries from insufficiently guided or uncontrolled machine.
Body parts could be cut off.

- ▶ If the machine is guided to the workpiece, the machine must always be held tight with both hands and stand securely.
- ▶ If the machine is on a stable foundation, hold the machine with one hand on the handle and hold the workpiece with the other hand.

NOTICE

Incorrect placement.
Premature wear of the knife.

- ▶ Make sure that the stop screw is adjusted to the diameter of the workpiece.
- ▶ Make sure that the cutting head and workpiece are perpendicular to each other.

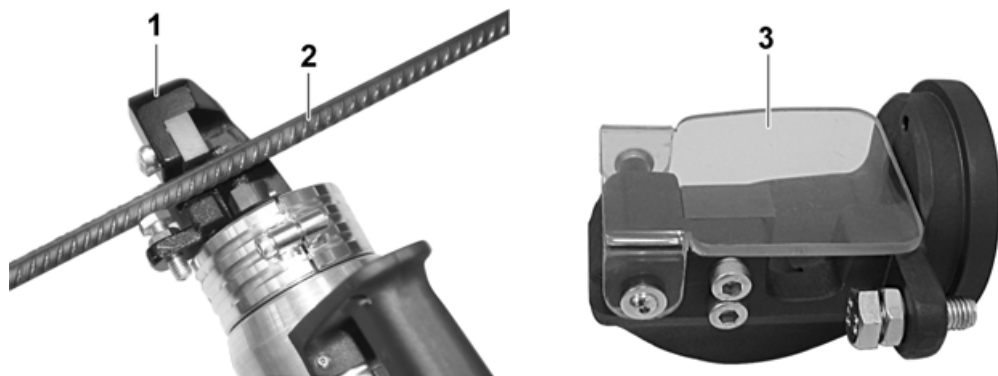

Item	Designation
1	Cutting head
2	Workpiece
3	Protective hood

1. Set pressure release lever in cutting operation position.
2. Open the protective hood (only installed on some machine designs).
3. Guide the workpiece in the cutting head.
4. Close the protective hood.
5. Press and hold ON/OFF switch.
6. If the knife again is in the original position, release the ON/OFF switch.

7.4 Decomissioning

Switching off the machine

1. Release ON/OFF switch.
2. Set the pressure release lever in the Release/Idle position.
The knife moves into the original position.
3. Pull the plug from the plug receptacle.

Cleaning the machine



CAUTION

Electrical voltage.

Danger of electrocution!

- Make sure when cleaning that no water gets into the machine. Do not clean machine under running water or with a high pressure cleaner.
-

1. Free the cutting head of cutting residues with suitable tools.
2. Wipe the housing with a damp and clean cloth.

8 Maintenance



WARNING

Improper handling can result in injury or serious material damage.

- Read and follow all safety instructions of this operator's manual, see chapter *Safety information*.



WARNING

Electrical voltage.

Injuries from electrocution.

- Remove the plug from the plug receptacle before all work on the machine.

8.1 Maintenance schedule

Task	Daily before operation	As required	Every 2 years
Check power cable for perfect condition – if power cable is defective, have it replaced.*	■		
Visual inspection of all parts for damage.	■		
Check knife for wear – if necessary, turn or replace knife.	■		
Check screws on machine for tightness – if necessary, tighten them.		■	
Check the hydraulic oil tank level for power loss or leaking hydraulic oil – if necessary add hydraulic oil.		■	
Change hydraulic oil.			■
RCP-12 and RCP-16: Check cutting head for complete closure – if necessary, adjust stroke.		■	

* Have these tasks carried out by the service department of your Wacker Neuson contact person.

8.2 Maintenance work

Work in the workshop

Perform maintenance work in a workshop on a workbench. This has the following benefits:

- Protection of the machine of contamination on the construction site.
- A level and clean work surface makes work easier.
- There is a better overview over small parts and they are not lost as easily.

8.2.1 Visual inspection for damage

Checking the machine



WARNING

A damaged machine part or power cable can result in personal injury caused by electric current.

- ▶ Do not operate a damaged machine.
 - ▶ Have a damaged machine repaired immediately.
-

- ▶ Check all machine parts for damage or cracks.

8.2.2 Changing the knife on the RCP-12

If the knives are worn, both knives need to be changed.

Remove the upper knife

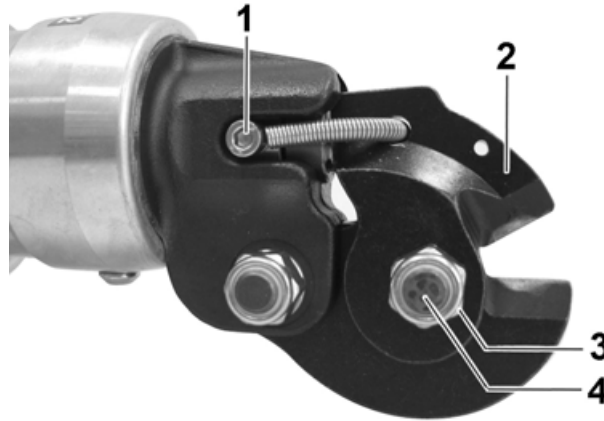

Item	Designation
1	Fastening screw of spring (2 pieces)
2	Upper knife
3	Nut
4	Bolt of upper knife

Performing preparations

1. Pull the plug from the plug receptacle.
2. Set the pressure release lever in the Release/Idle position.
The upper knife moves into the original position.

Remove the upper knife

1. Unscrew the fastening screws of the spring on both sides and remove them.
2. Remove the spring.
3. Unscrew the nut on the bolt of the upper knife and remove it.
4. Pull out the bolt.
5. Remove the upper knife.

Changing the lower knife

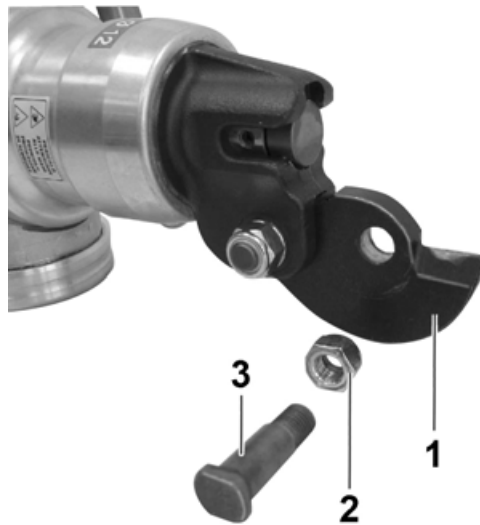

Item	Designation
1	Lower knife
2	Nut
3	Bolt of lower knife

Remove the lower knife

1. Unscrew the nut on the bolt of the lower knife and remove it.
2. Pull out the bolt.
3. Remove the lower knife.

Install the lower knife

1. Install the lower knife in a way that the holes for the bolt are aligned.
2. Install the bolt.
3. Position the nut and tighten it.

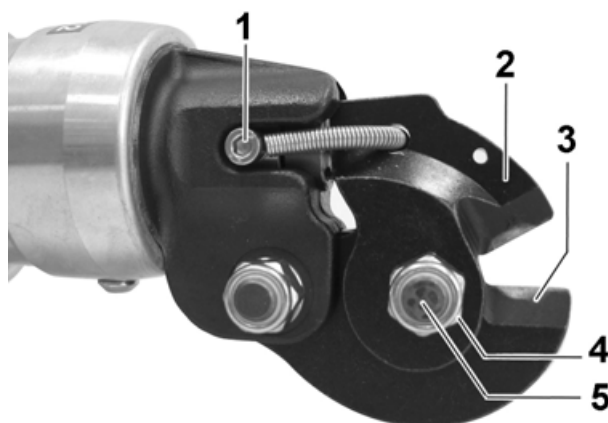
Install the upper knife

Item	Designation
1	Fastening screw of spring (2 pieces)
2	Upper knife
3	Lower knife
4	Nut
5	Bolt

1. Set the upper knife on the lower knife so that the holes for the bolt are aligned.
2. Install the bolt.

NOTICE

Loose knife.

Premature wear of the machine.

► Always use a new nut.

3. Position the nut and tighten it. Only tighten the nut so that the upper knife can still move.
4. Tighten both ends of the spring with the two fastening screws.

8.2.3 Changing the knife on the RCP-16

Each knife has 3 blades. If one blade is worn-out, turn the knife and adjust so that an unworn blade is used for cutting.

Removing the upper knife holder

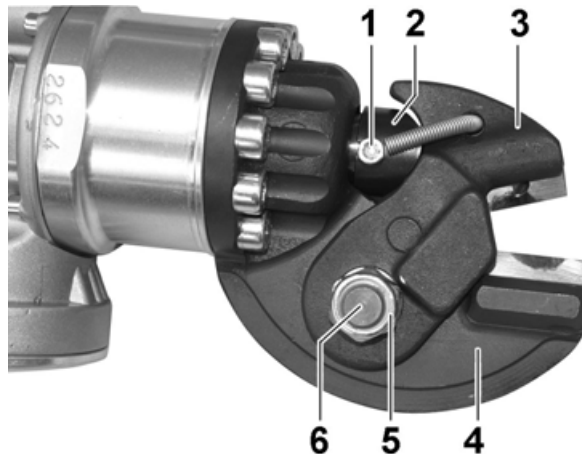

Item	Designation
1	Fastening screw of spring (2 pieces)
2	Thrust head
3	Upper knife holder
4	Lower knife holder
5	Nut with lock washer
6	Bolt

Performing preparations

1. Pull the plug from the plug receptacle.
2. Set the pressure release lever in the Release/Idle position.
The upper knife holder moves into the original position.

Removing the upper knife holder

1. Unscrew the fastening screws of the spring on both sides and remove them.
2. Remove the thrust head from the thrust bolt.
3. Unscrew nut and remove with the lock washer.
4. Pull out the bolt.
5. Remove upper knife holder.

Turning or replacing knife

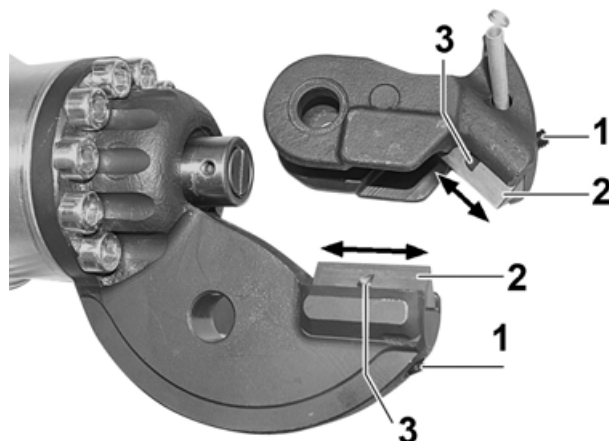

Item	Designation
1	Outer setscrew (2 pieces)
2	Knife
3	Groove
	Inner setscrew (2 pieces) (no illustration)

Remove both knives

1. Unscrew outer setscrew.
Inner setscrew is accessible.
2. Loosen inner setscrew.
3. Remove knife towards the front.
If the knife is jammed, set a mandril on the groove in the knife and carefully tap out the knife.
4. Clean knife retainer on knife holder.

Install both knives

1. Insert knife with a blade that is not worn.
If necessary insert a new knife.
2. Tighten inner setscrew.
3. Screw in the outer set screw and hand tighten it.

Installing the upper knife holder

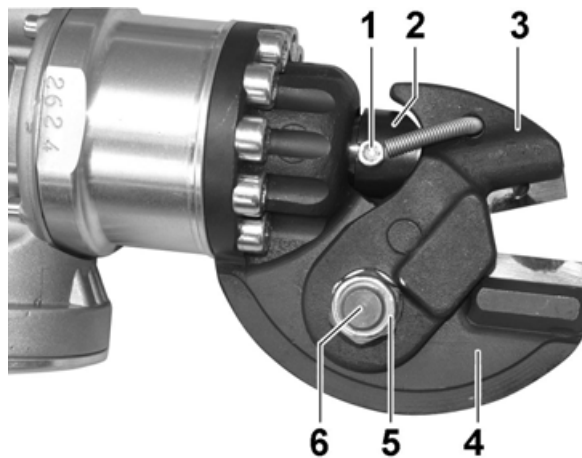

Item	Designation
1	Fastening screw of spring (2 pieces)
2	Thrust head
3	Upper knife holder
4	Lower knife holder
5	Nut with lock washer
6	Bolt

1. Set the upper knife holder on the lower knife holder so that the holes for the bolt are aligned.
2. Install the bolt.

NOTICE

Loose knife holder.
Premature wear of the machine.
► Always use a new nut.

3. Place on nut with lock washer and tighten. Only tighten the nut so that the upper knife holder can still move.

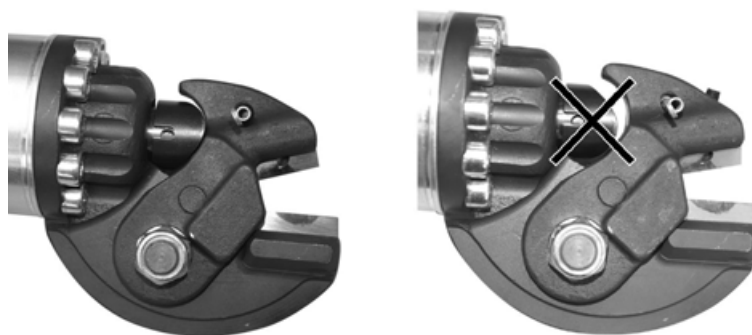

4. Put the thrust head on the thrust bolt and align so that the thrust head fits into the curvature of the upper knife holder.
5. Tighten both ends of the spring with the two fastening screws.

8.2.4 Changing the knife on the RCP-32

Changing the knife

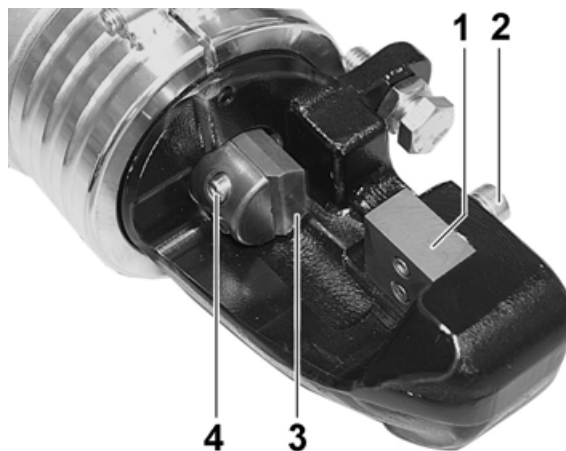

Item	Designation
1	Fixed knife
2	Fastening screws (2 pieces)
3	Movable knife
4	Fastening screws with spring washers (2 pieces)

Performing preparations

1. Pull the plug from the plug receptacle.
2. Open the protective hood (only installed on some machine designs).

Changing the fixed knife

1. Unscrew both fastening screws on the fixed knife.
2. Changing fixed knife.
3. Tighten fixed knife with both fastening screws.

Changing the movable knife

1. Unscrew both fastening screws on the movable knife and remove with the spring washers
2. Changing movable knife.
3. Tighten movable knife with both fastening screws and spring washers.

8.2.5 Adjusting the stroke for RCP-12

If the knives do not close sufficiently during cutting the thrust bolt and knives are worn. In this case the stroke on the thrust bolts has to be adjusted.

Unscrew the spring

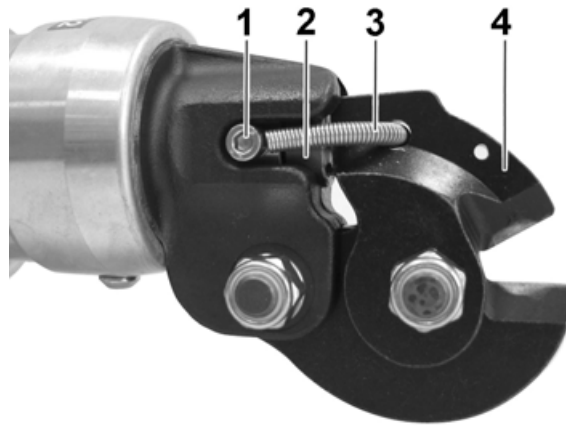

Item	Designation
1	Fastening screw of spring (2 pieces)
2	Thrust bolt
3	Spring
4	Upper knife

Performing preparations

1. Pull the plug from the plug receptacle.
2. Set the pressure release lever in the Release/Idle position.
The upper knife moves into the original position.

Unscrew the spring

- Unscrew the fastening screws of the spring on both sides and remove them.

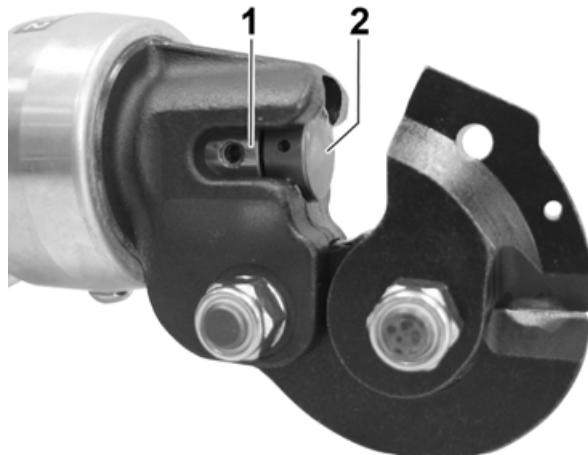
Adjusting the stroke

Item	Designation
1	Thrust bolt
2	Adjusting screw

Use the adjusting screw in the thrust bolt to set the stroke:

- ▶ To increase the stroke use a pin (\varnothing 4 mm) and turn the adjusting screw counter clockwise.
- ▶ To decrease the stroke use a pin (\varnothing 4 mm) and turn the adjusting screw clockwise.

Fasten the spring

- ▶ Tighten both ends of the spring with the two fastening screws.

8.2.6 Adjusting the stroke for RCP-16

If the knives do not close sufficiently during cutting the thrust head and knife holder are worn. In this case the stroke on the thrust bolts has to be adjusted.

Remove the thrust head

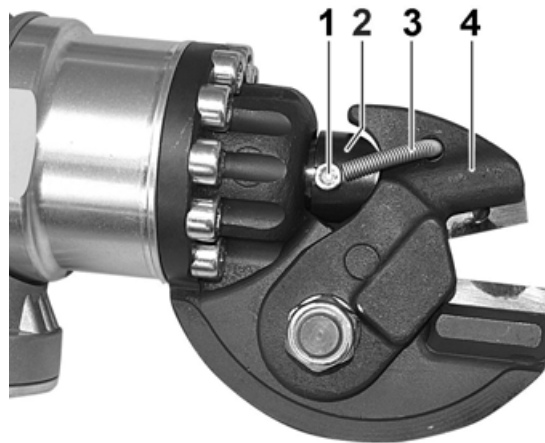

Item	Designation
1	Fastening screw of spring (2 pieces)
2	Thrust head
3	Spring
4	Upper knife holder

Performing preparations

1. Pull the plug from the plug receptacle.
2. Set the pressure release lever in the Release/Idle position.
The upper knife holder moves into the original position.

Remove the thrust head

1. Unscrew the fastening screws of the spring on both sides and remove them.
2. Remove the thrust head from the thrust bolt.

Adjusting the stroke

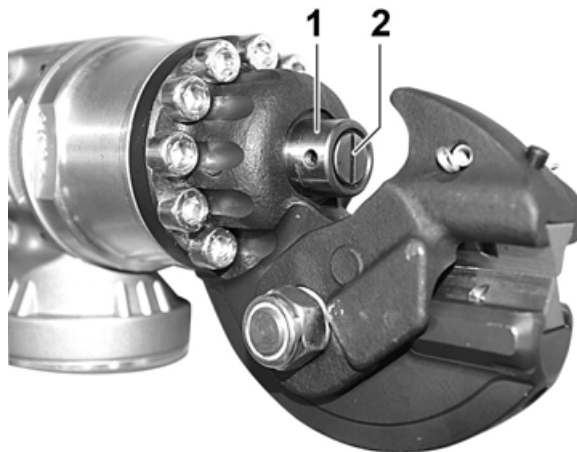

Item	Designation
1	Thrust bolt
2	Adjusting screw

Use the adjusting screw in the thrust bolt to set the stroke:

- ▶ Turn the adjusting screw counter clockwise with a screwdriver to increase the stroke.
- ▶ Turn the adjusting screw clockwise with a screwdriver to decrease the stroke.

Install thrust head

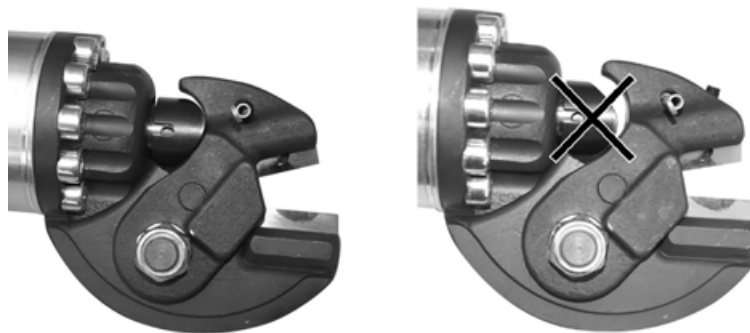

1. Put the thrust head on the thrust bolt and align so that the thrust head fits into the curvature of the upper knife holder.
2. Tighten both ends of the spring with the two fastening screws.

8.2.7 Checking the hydraulic oil level



WARNING

Hot hydraulic oil.

Injury by scalding.

- ▶ Do not open the screw plug on the oil filler neck as long as the hydraulic oil is hot.
 - ▶ Let machine cool off.
-



CAUTION

Hydraulic oil under pressure.

Squirting hydraulic oil can penetrate the skin.

- ▶ Only unscrew the screw plug on the oil filler neck if the thrust bolt is completely extended.
 - ▶ Wear safety glasses and protective gloves.
-

NOTICE

Wrong hydraulic oil.

Damage to machine.

- ▶ Only fill with hydraulic oils which are specified for the machine in the chapter *Technical Data*.
-



Item	Designation
1	Oil filler neck
2	Screw plug

Performing preparations

1. Completely extend the thrust bolt. For this press the ON/OFF switch.
2. Pull the plug from the plug receptacle.
3. Remove any dirt around the screw plug.

Checking the hydraulic oil level

1. Place the machine so that the oil filler neck points vertically upward.
2. Open the screw plug on the oil filler neck slowly and carefully.
Hold a cloth over the oil filler neck with the second hand for protection against escaping hydraulic oil.
3. Unscrew the screw plug on the oil filler neck and remove with sealing ring.
4. Check if the hydraulic oil reaches to the lower edge of the oil filler neck.
If necessary, fill with hydraulic oil up to the lower edge of the oil filler neck.
5. Screw in the screw plug with sealing ring in the oil filler neck and tighten.

8.2.8 Changing the hydraulic oil

Change hydraulic oil when it is lukewarm. The oil then flows easier.



Item	Designation
1	Oil filler neck
2	Screw plug

Draining out the hydraulic oil



WARNING

Hot hydraulic oil.

Injury by scalding.

- ▶ Do not open the screw plug on the oil filler neck as long as the hydraulic oil is hot.
- ▶ Let machine cool off.



CAUTION

Hydraulic oil under pressure.

Squirting hydraulic oil can penetrate the skin.

- ▶ Only unscrew the screw plug on the oil filler neck if the thrust bolt is completely extended.
- ▶ Wear safety glasses and protective gloves.

Note: The work area should be covered with a waterproof sheet to protect the floor (protection of the environment).

Performing preparations

1. Have a suitable collecting container ready.
2. Completely extend the thrust bolt. For this press the ON/OFF switch.
3. Pull the plug from the plug receptacle.

Draining out the hydraulic oil

1. Place the machine so that the oil filler neck points vertically upward.
2. Open the screw plug on the oil filler neck slowly and carefully.
Hold a cloth over the oil filler neck with the second hand for protection against escaping hydraulic oil.
3. Unscrew the screw plug on the oil filler neck and remove with sealing ring.
4. Hold the machine with the oil filler neck over the collection container and drain hydraulic oil.
5. Set the pressure release lever in the Release/Idle position.
6. When the thrust bolt is completely retracted drain the remaining hydraulic oil in the collection container.

Note: Dispose of hydraulic oil according to the applicable regulations for environmental protection.

Filling with hydraulic oil

NOTICE

Wrong hydraulic oil.
Damage to machine.

- Only fill with hydraulic oils which are specified for the machine in the chapter *Technical Data*.
-

Filling with hydraulic oil

1. Place the machine so that the oil filler neck points vertically upward.
2. Fill with hydraulic oil up to the lower edge of the oil filler neck.
3. Screw in the screw plug with sealing ring in the oil filler neck and tighten.

Distribute the hydraulic oil

1. Insert the plug into the plug receptacle.
2. Run the machine in cutting operation approx. 3 times back and forth. For this press the ON/OFF switch.
3. Completely extend the thrust bolt.
4. Pull the plug from the plug receptacle.

Top up with hydraulic oil

1. Place the machine so that the oil filler neck points vertically upward.
2. Unscrew the screw plug on the oil filler neck and remove with sealing ring.
3. Fill with hydraulic oil up to the lower edge of the oil filler neck.
4. Screw in the screw plug with sealing ring in the oil filler neck and tighten.



9 Troubleshooting

Potential faults, their causes and the respective remedies are listed in the following table.

Malfunction	Cause	Remedy
Workpiece jammed or slipped (only RCP-32).	Stop screw is set incorrectly.	Adjust the stop screw.
Machine not in operation.	Input voltage too high or too low.	Provide correct voltage; if necessary use an extension cable with sufficient cross section.
	Power cable interrupted.	Check power cable, have it replaced if defective. *
Thrust bolt moves out incompletely or unevenly.	Insufficient hydraulic oil in the hydraulic oil tank.	Check oil level, fill with hydraulic oil if necessary.
	Cold hydraulic oil.	Warm up machine for approx. 1 minute.
Thrust bolt does not move back completely.	Dirt and cutting residue in the cutting head.	Clean cutting head.
Hydraulic oil is leaking out.	Sealing ring on the oil filler neck is damaged.	Check sealing ring, change if necessary.
	Leak on the hydraulic cylinder, hydraulic oil tank or screwed connections.	Have the machine repaired. *

* Have these tasks carried out by the service department of your Wacker Neuson contact person.

10 Disposal

10.1 Disposal of waste electrical and electronic equipment

For customers in EU countries

This device is subject to the European Directive 2002/96/EC on waste electrical and electronic equipment (WEEE) and the corresponding national legislation. The WEEE directive outlines the procedure for handling electrical waste equipment across the EU.



The device is labelled with the symbol of a crossed out dustbin shown here. This means you may not dispose of it with normal household waste but in a separate environmentally-friendly waste collection.

This device is a professional electrical tool designed for commercial applications only (B2B device according to WEEE directive). Contrary to equipment used in most private households (B2C devices), in some EU countries such as Germany, this device may not be disposed of at a collection point in a public disposal facility (for example at public waste depots). In case of doubt, ask the sales outlet about the proper disposal procedure for B2B electrical equipment in your country and ensure you dispose of the device in accordance with the valid legal guidelines. Please also note any information in the sales contract and the general terms and conditions from the point of sales.

The proper disposal of this device prevents the occurrence of any negative effects on people or the environment, follows the specific procedures for handling harmful substances and enables valuable raw materials to be recycled.

For customers in non-EU countries

The proper disposal of this device prevents the occurrence of any negative effects on people or the environment, follows the specific procedures for handling harmful substances and enables valuable raw materials to be recycled. Therefore, we recommend that this device is disposed of in a separate, environmentally-friendly waste collection and not with normal household waste. In some cases, national legislation also stipulates the separate disposal of electric and electronic products. Please ensure you dispose of this device in accordance with the valid regulations in your country.

11 Accessories

The following accessories are offered for the machine:

- For RCP-12 and RCP-16 an additional handle is available.
- For RCP-16 an extension for vertical work is available.

For more information on the individual accessories, visit the following website:
www.wackerneuson.com.

12 Technical data

12.1 RCP-12/16/32 - 230

Designation	Unit	RCP-12	RCP-16	RCP-32
Item no.		0610197	0610199	0610205
Length x Width x Height	mm (in)	510 x 110 x 135 (20.1 x 4.3 x 5.3)	520 x 130 x 120 (20.5 x 5.1 x 4.7)	560 x 180 x 335 (22.1 x 7.1 x 13.2)
Operating weight	kg (lb)	7.5 (16.5)	10.4 (22.9)	27.6 (60.8)
Rated voltage	V	230 1~		
Rated frequency	Hz	50		
Rated power consumption	W	1,200	1,100	1,400
Rated current consumption	A	5.8	5.3	6.8
Class rating		II		
Protection class		IP 20		
Engine speed	rpm	10,000	10,000	14,000
Operating temperature	°C (°F)	-20 to +50 (-4 to +122)		
Hydraulic oil, specification		HLP-ISO-46		
Hydraulic oil, fill quantity	l (gal)	0.6 (0.16)		
Max. compressive force	t	7	10	50
Opening/closing time of the tool	s	5	4	6
Max. allowable tension strength of the workpiece	N/mm ²	750		
Max. allowable diameter workpiece	mm (in)	12 (0.47)	16 (0.63)	32 (1.26)
Protective hood		—	—	—
Sound power level L _{WA} in cutting operation	dB(A)	90	100	102
Sound pressure level at operator's station L _{PA} in cutting operation	dB(A)	82	92	94

12.2 RCP-12/16/32 - 115

Designation	Unit	RCP-12	RCP-16	RCP-32
Item no.		0610213	0610214	0610217
Length x Width x Height	mm (in)	510 x 110 x 135 (20.1 x 4.3 x 5.3)	520 x 130 x 120 (20.5 x 5.1 x 4.7)	560 x 180 x 335 (22.1 x 7.1 x 13.2)
Operating weight	kg (lb)	7.5 (16.5)	10.4 (22.9)	27.6 (60.8)
Rated voltage	V	115 1~		
Rated frequency	Hz	50		
Rated power consumption	W	1,100	1,200	1,300
Rated current consumption	A	9.2	10.0	11.0
Class rating		II		
Protection class		IP 20		
Engine speed	rpm	10,000	10,000	14,000
Operating temperature	°C (°F)	-20 to +50 (-4 to +122)		
Hydraulic oil, specification		HLP-ISO-46		
Hydraulic oil, fill quantity	l (gal)	0.6 (0.16)		
Max. compressive force	t	7	10	50
Opening/closing time of the tool	s	5	4	6
Max. allowable tension strength of the workpiece	N/mm ²	750		
Max. allowable diameter workpiece	mm (in)	12 (0.47)	16 (0.63)	32 (1.26)
Protective hood		—	—	■
Sound power level L _{WA} in cutting operation	dB(A)	90	100	102
Sound pressure level at operator's station L _{PA} in cutting operation	dB(A)	82	92	94

12.3 RCP-12/16/32 - 120

Designation	Unit	RCP-12	RCP-16	RCP-32
Item no.		0610198	0610200	0610206
Length x Width x Height	mm (in)	510 x 110 x 135 (20.1 x 4.3 x 5.3)	520 x 130 x 120 (20.5 x 5.1 x 4.7)	560 x 180 x 335 (22.1 x 7.1 x 13.2)
Operating weight	kg (lb)	7.5 (16.5)	10.4 (22.9)	27.6 (60.8)
Rated voltage	V	120 1~		
Rated frequency	Hz	60		
Rated power consumption	W	1,100	1,200	1,300
Rated current consumption	A	9.2	10.0	11.0
Class rating		II		
Protection class		IP 20		
Engine speed	rpm	10,000	10,000	14,000
Operating temperature	°C (°F)	-20 to +50 (-4 to +122)		
Hydraulic oil, specification		HLP-ISO-46		
Hydraulic oil, fill quantity	l (gal)	0.6 (0.16)		
Max. compressive force	t	7	10	50
Opening/closing time of the tool	s	5	4	6
Max. allowable tension strength of the workpiece	N/mm ²	750		
Max. allowable diameter workpiece	mm (in)	12 (0.47)	16 (0.63)	32 (1.26)
Protective hood		—	—	■
Sound power level L _{WA} in cutting operation	dB(A)	90	100	102
Sound pressure level at operator's station L _{PA} in cutting operation	dB(A)	82	92	94

12.4 Extension cable



WARNING

Electrical voltage.

Injuries from electrocution.

- ▶ Check power cable and extension cable for signs of damage.
- ▶ Only use extension cables for which grounded conductors are connected to the plug and the coupling (only for machines of class rating I, see chapter *Technical Data*).

- Only use permitted extension cables, see chapter *Safety*.
- Refer to the following table for the required cross-section area of the extension cable:

Note: Refer to the nameplate or the chapter *Technical data* (via the item number) for the type designation and voltage rating of your machine.

Machine	Voltage [V]	Extension [m]	Cross-section area of cable [mm ²]
RCP-12	115	< 33	1.5
		< 54	2.5
		< 86	4
		< 128	6
	120	< 34	1.5
		< 56	2.5
		< 90	4
		< 133	6
	230	< 103	1.5
		< 150	2.5

Machine	Voltage [V]	Extension [m]	Cross-section area of cable [mm ²]
RCP-16	115	< 30	1.5
		< 50	2.5
		< 79	4
		< 118	6
	120	< 31	1.5
		< 52	2.5
		< 82	4
		< 122	6
	230	< 113	1.5
		< 150	2.5
RCP-32	115	< 22	1.5
		< 37	2.5
		< 59	4
		< 87	6
	120	< 28	1.5
		< 47	2.5
		< 75	4
		< 111	6
	230	< 88	1.5
		< 146	2.5

Extension cable for the US market:

Machine	Voltage [V]	Extension [ft]	Cross-section area of cable [AWG]
RCP-12	115	< 92	16
		< 148	14
		< 233	12
		< 371	10
	120	< 98	16
		< 154	14
		< 243	12
		< 384	10
	230	< 295	16
		< 469	14
RCP-16	115	< 85	16
		< 135	14
		< 217	12
		< 341	10
	120	< 89	16
		< 141	14
		< 223	12
		< 354	10
	230	< 325	16
		< 492	14

Machine	Voltage [V]	Extension [ft]	Cross-section area of cable [AWG]
RCP-32	115	< 79	16
		< 125	14
		< 197	12
		< 308	10
	120	< 82	16
		< 128	14
		< 203	12
		< 322	10
	230	< 253	16
		< 400	14
		< 492	12

Example

You utilize a RCP-12/230 and want to use an extension cable with a length of 50 m (164 ft).

The machine has an input voltage of 230 V.

According to the table, the extension cable must feature a cross-section area of 1.5 mm² (AWG 16).

13 Glossary

Class rating

The class rating according to DIN EN 61140 specifies the safety measures for electrical equipment to avoid electrocution. There are four class ratings:

Class rating	Meaning
0	No special protection apart from the basic insulation. No grounded conductor. Plug connection without grounded conductor contact.
I	Connection of all conductive housing components to the grounded conductor. Plug connection with grounded conductor contact.
II	Reinforced or double insulation (protective insulation). No connection to the grounded conductor. Plug connection without grounded conductor contact.
III	Machines are operated on protective low voltage (< 50 V). Connection to the grounded conductor is not necessary. Plug connection without grounded conductor contact.

Protection class IP

The protection class according to DIN EN 60529 indicates the suitability of electrical equipment for use in certain ambient conditions as well as the protection against risks.

The protection class is specified by an IP code according to DIN EN 60529.

Code	Meaning 1st number: Protection against touching hazardous parts. Protection against permeating foreign objects.
0	Not protected against contact. Not protected against foreign bodies.
1	Protected against contact with the back of the hand. Protected against large foreign objects with diameter > 50 mm (1.9 in).
2	Protected against contact with one finger. Protected against medium-sized foreign objects (diameter > 12.5 mm (0.5 in)).
3	Protected against touch with a tool (diameter > 2.5 mm (0.01 in)). Protected against small foreign objects with (diameter > 2.5 mm (0.01 in)).
4	Protected against touch with a wire (diameter > 1 mm (0.03 in)). Protected against granular foreign objects (diameter > 1 mm (0.03 in)).
5	Protected against contact. Protected against dust depositing inside.
6	Completely protected against any contact. Protected from dust.

Code	Meaning 2nd number: Protection against permeating water
0	Not protected against permeating water.
1	Protected against water dropping vertically.
2	Protected against diagonally falling water (15° angle).
3	Protected against spray (60° angle).
4	Protected against spraying water from all directions.
5	Protected against water jets (nozzle) from any angle.
6	Protected against strong water jets (overflow).
7	Protected from temporary immersion in water.
8	Protected from ongoing immersion in water.



**WACKER
NEUSON**

EC Declaration of Conformity

Manufacturer

Wacker Neuson Produktion GmbH & Co. KG, Preußenstraße 41, 80809 München

Product

Product	RCP 12	RCP 16	RCP 32
Product category	Cutting machine		
Product function	Cutting reinforcing steel		
Item number	0610197, 0610198, 0610213	0610199, 0610200, 0610214	0610205, 0610206, 0610217

Guidelines and standards

We hereby declare that this product meets and complies with the relevant regulations and requirements of the following guidelines and standards:

2006/42/EG, 2006/95EG, 2004/108/EG, EN 61000, EN 55014

Authorized person for technical documents

Axel Häret,

Wacker Neuson Produktion GmbH & Co. KG, Preußenstraße 41, 80809 München

München, 01.08.2011

Dr. Michael Fischer
Director of Technology and Innovation

Translation of the original Declaration of Conformity

Wacker Neuson SE, Preußenstraße 41, D-80809 München, Tel.: +49-(0)89-3 54 02-0 Fax: +49 - (0)89-3 54 02-390

Wacker Neuson Production Americas LLC, N92W15000 Anthony Ave., Menomonee Falls, WI 53051

Tel.: (262) 255-0500 Fax: (262) 255-0550 Tel.: (800) 770-0957

Wacker Neuson Limited - Room 1701-03 & 1717-20, 17/F. Tower 1, Grand Century Place, 193 Prince Edward Road West, Mongkok, Kowloon, Hongkong.
Tel: (852) 3605 5360, Fax: (852) 2758 0032