

## Scaffold Trolley Technical Specification

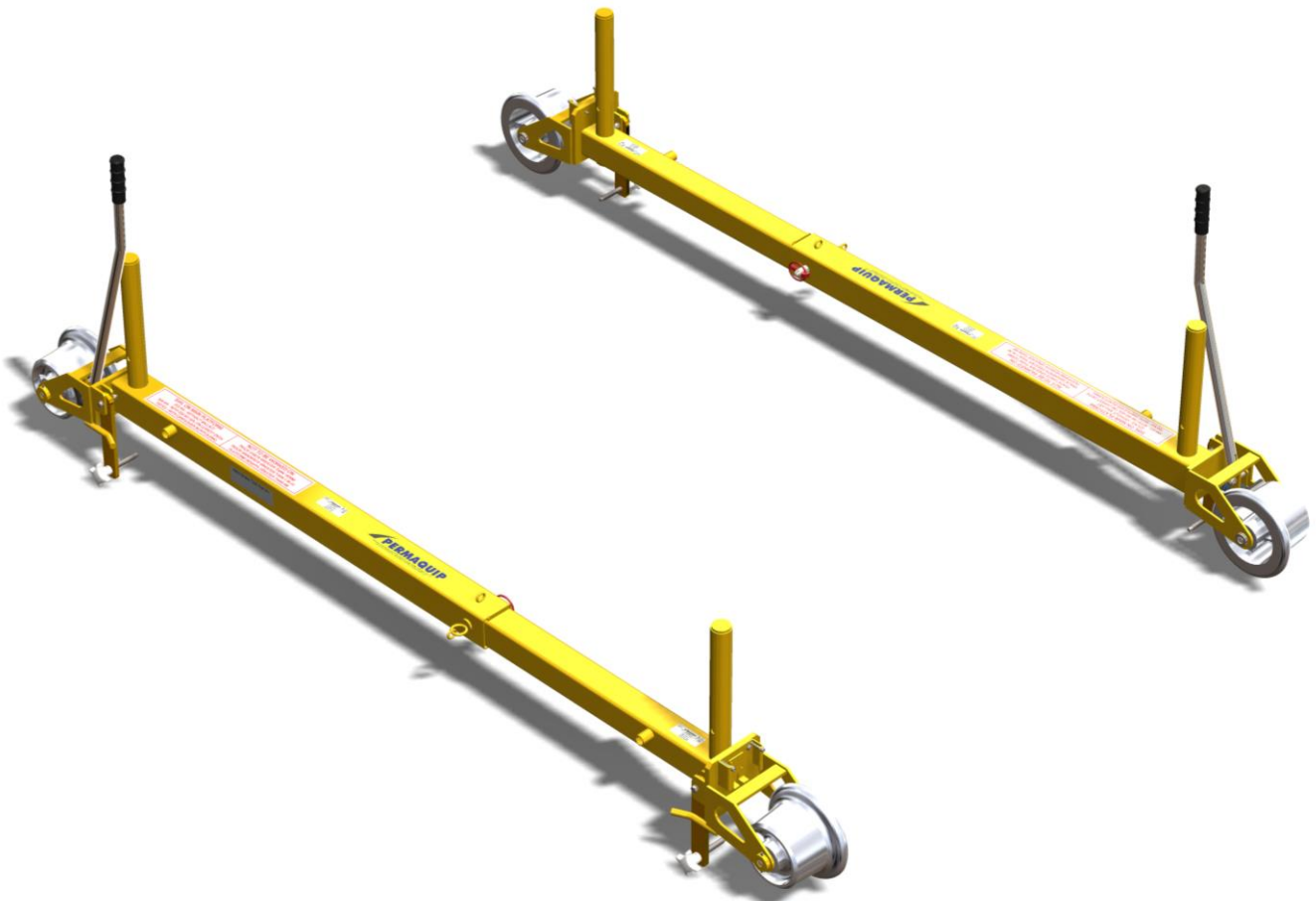

### **Description:**

The Permaquip™ Scaffold Trolley is designed for use on-track in conjunction with the Boss Zone 1 1450 x 1.8/2.5 (fibreglass construction) and the Boss Ladderspan or Staircase 1450 x 1.8/2.5 (aluminium construction) tower systems to access areas above the rail head.

Each Scaffold Trolley is equipped with a fail-safe braking system and is supplied with Brake Handles.

### **Please note:**

All information, illustrations and specifications in this Technical Sheet are based on the latest information available at the time of publication. The right is reserved to make changes at any time without notice.

Equipment operators and installers shall be responsible for ensuring that a safe working environment and safe systems of work are in place and in certain circumstances advice and permission from the controlling authority must be sought before any operation, installation or surveying work is carried out.

Permaquip™ is a trademark of Permaquip Ltd.

©2006 Permaquip Ltd.

### *Hire From:*

PSM Plant & Tool Hire Centres Ltd, Head Office, 253-255 Blackfen Road, Blackfen, Sidcup, Kent DA15 8PR

Tel: 020 8850 5658 / Fax: 020 8859 4377

E-mail: [info@psmhire.co.uk](mailto:info@psmhire.co.uk) / [www.psmhire.co.uk](http://www.psmhire.co.uk)

## Scaffold Trolley Layout:

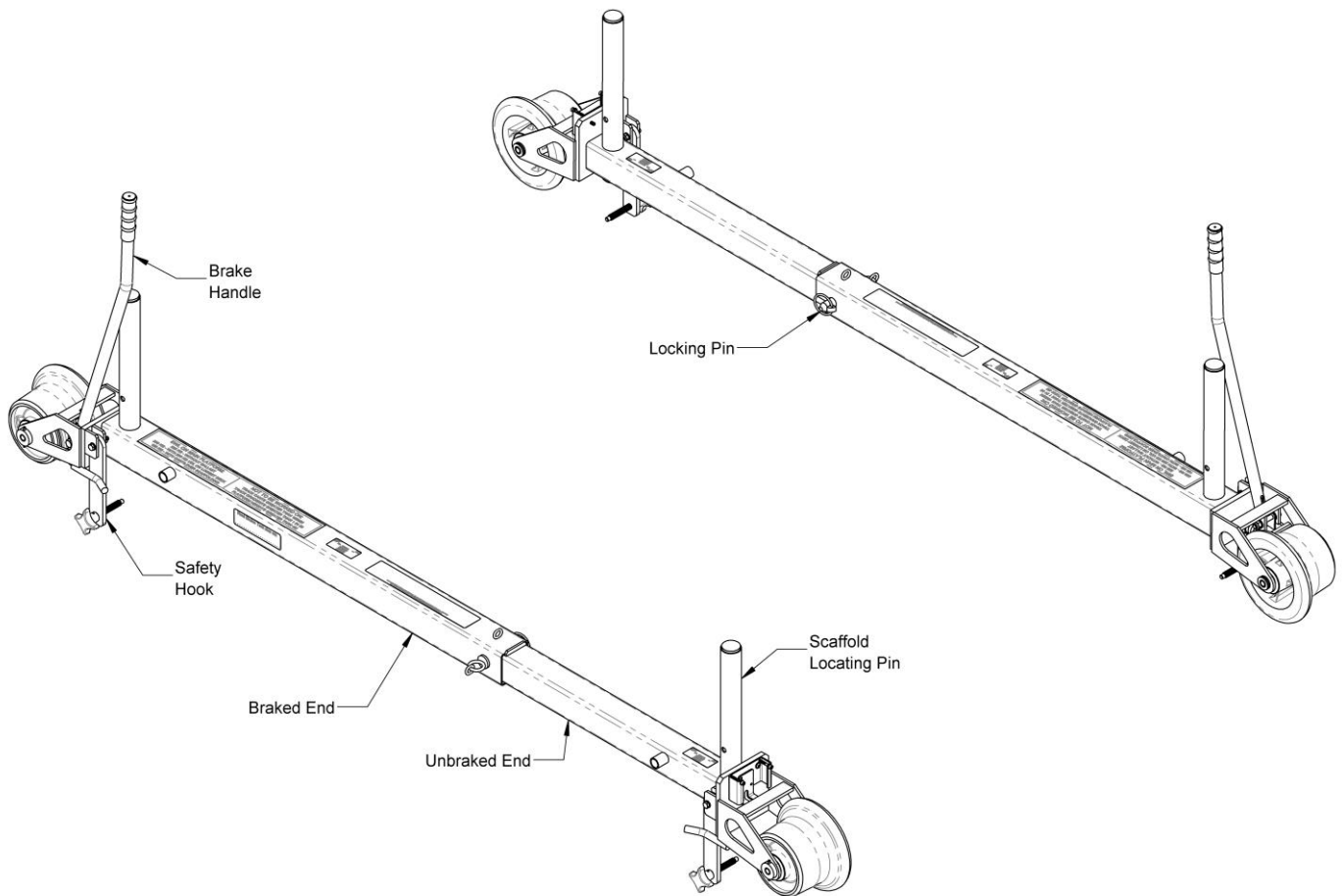

### Technical Data:

#### Scaffold Trolley Part Numbers:

- Scaffold Trolley 33014

#### Overall dimensions:

- Length (Stored) 2450mm
- Length (1.8m Tower) 2550mm
- Length (2.5m Tower) 3150mm
- Height (To top of Scaffold Locating Pin) 501mm
- Height (To top of Brake Handle) 806mm
- Width 1693mm

#### Platform Dimensions:

- Maximum platform height above track 5m
- Maximum platform height above track moving with personnel at a maximum cant of 50mm 4m

#### Track Gauge:

1435mm

#### SWL:

- Maximum SWL on main platform without ballast 225kg
- Maximum SWL with 200 kg ballast UDL on lower deck 300kg
- Maximum SWL with side cantilever extension platforms 150kg
- Mass of each trolley side 40kg

Wheels:

- Material: Aluminium
- Profile: P1
- Rolling Diameter: 6"

Brakes: Failsafe braking as standard tested in line with CoP 0018

Maximum Cant: 150mm

Maximum Gradient: 1 in 30

Product Compliance:

- RIS-1701PLT

# Permaquip Scaffold Trolley

